

DETAILInspiration

THE DIGITAL RESEARCH TOOL FOR ARCHITECTS

- 1. How can I find suitable projects for my research?
- 2. What kind of information can I find for each project?
- 3. How can I save and download suitable projects?

→ detail.de/inspiration



DETAIL Inspiration

THE DIGITAL RESEARCH TOOL FOR ARCHITECTS

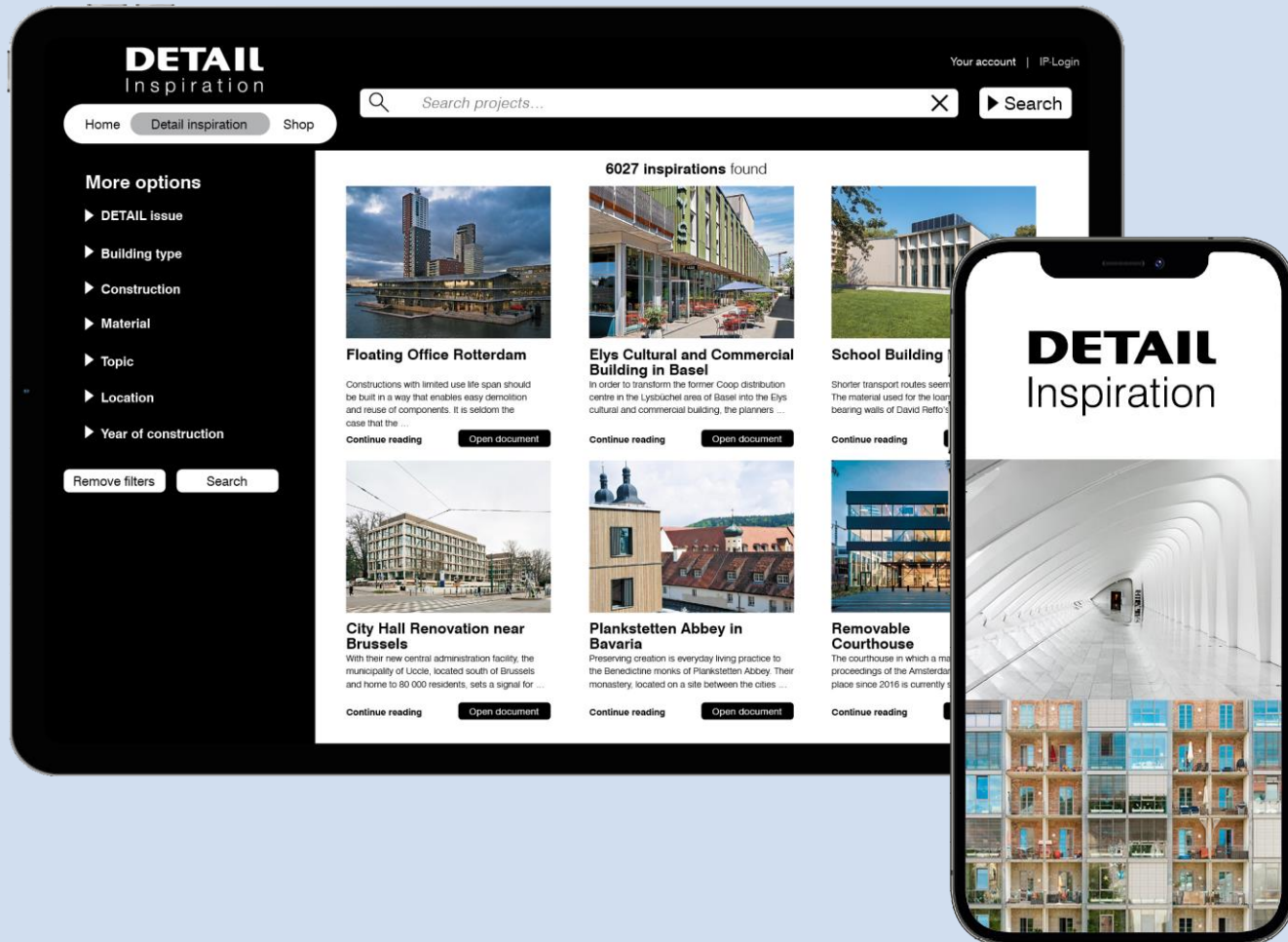

- Extensive project descriptions and detail drawings
- Professional search and filter functions
- Constantly expanding database
- Location-independent access
- 4,000+ projects in English /6,000+ projects in German

→ detail.de/inspiration



1. How can I find suitable projects for my research?

Either you use the keyword search...

The screenshot displays the DETAIL Inspiration website interface. At the top, the navigation bar includes 'Home', 'Detail Inspiration', and 'Shop'. A search bar is prominently featured, with the word 'timber' entered and a dropdown menu showing a list of project suggestions. The suggestions include 'Timber Construction in Norway', 'Timber Frame House, Penzberg', 'Timber High-rise Balconies in Practical Test', 'Timber High-Rise in Brumundda', 'Timber Office High-Rise in Risch-Rotkreuz', 'Timber Parking Garage in Bad Aibling', 'Timber Pavilion in Pachacámac', and 'Timber-earth Solid Ceilings'. Below the search bar, the website is divided into three main project sections. Each section features a large image of the project, a title, a brief description, and two buttons: 'Continue reading' and 'Open document'. The first project is 'Holiday Home in the Vosges', the second is 'BOB-Campus in Wuppertal', and the third is '47 Council Apartments in Barcelona'. The footer of the website contains links to 'Newsletter', 'Terms & Conditions', 'FAQ', 'Privacy statement', 'About DETAIL', 'Contact', and 'Legal notice', along with the DETAIL logo.

DETAIL
Inspiration

Home Detail Inspiration Shop

More options

- ▶ DETAIL issue
- ▶ Building type
- ▶ Construction
- ▶ Material
- ▶ Topic
- ▶ Location
- ▶ Year of construction

Remove filters Search

Search: timber

- Timber Construction in Norway
- Timber Frame House, Penzberg
- Timber High-rise Balconies in Practical Test
- Timber High-Rise in Brumundda
- Timber Office High-Rise in Risch-Rotkreuz
- Timber Parking Garage in Bad Aibling
- Timber Pavilion in Pachacámac
- Timber-earth Solid Ceilings

Holiday Home in the Vosges
In order to spend the holidays and weekends in their home country, the clients – a family with two children, living in Nancy – desired a ...
Continue reading Open document

BOB-Campus in Wuppertal
The reuse of existing buildings is a central aim of sustainable construction, since it is the most effective way of conserving resources. It is all t...
Continue reading Open document

47 Council Apartments in Barcelona
Back to simple solutions and building physics know-how from centuries ago – this is the approach chosen for the 47 council apartments on the so...
Continue reading Open document

Deutsch

Newsletter | Terms & Conditions | FAQ | Privacy statement | About DETAIL | Contact | Legal notice |

DETAIL

1. How can I find suitable projects for my research?

...or you use the predefined categories for your search.

The screenshot displays the DETAIL Inspiration website interface. At the top, the header includes the 'DETAIL Inspiration' logo, a search bar with the text 'timber', and navigation links for 'Newsletter', 'My Collections', 'Your account', and 'Sign out'. Below the header, a navigation bar shows 'Home', 'DETAIL Inspiration', and 'Shop'. A red circle highlights the 'More options' button in the left sidebar, with a red arrow pointing to it. The sidebar also lists categories like 'DETAIL issue', 'Building type', 'Construction', and 'Material'. The 'Material' section is expanded, showing a list of materials with checkboxes: Glass, Loam, Masonry, Plastics, Reinforced concrete, Steel / Aluminium, and Wood (which is checked). Below this, there is a 'Topic' section. The main content area displays '4202 inspirations found' and three project cards. Each card features a star icon, a photograph of the building, a title, a brief description, and buttons for 'Continue reading' and 'Open document'. The projects shown are 'Holiday Home in the Vosges', 'BOB-Campus in Wuppertal', and '47 Council Apartments in Barcelona'. At the bottom, there is a footer with links for 'Newsletter', 'Terms & Conditions', 'FAQ', 'Privacy statement', 'About DETAIL', 'Contact', and 'Legal notice', along with the DETAIL logo and a 'to top' button.

DETAIL
Inspiration

Home | **DETAIL Inspiration** | Shop

Search: timber

More options

- ▶ DETAIL issue
- ▶ Building type
- ▼ Construction
 - ▶ Facade construction
 - ▶ Roof construction
 - ▶ Support structure construction
- ▼ Material
 - ▶ Facade material
 - ▶ Interior work material
 - ▶ Roof material
 - ▼ Support structure material
 - ☐ All
 - ☐ Glass
 - ☐ Loam
 - ☐ Masonry
 - ☐ Plastics
 - ☐ Reinforced concrete
 - ☐ Steel / Aluminium
 - ☒ Wood
- ▶ Topic

4202 inspirations found

Holiday Home in the Vosges
In order to spend the holidays and weekends in their home country, the clients – a family with two children, living in Nancy – desired a ...
[Continue reading](#) [Open document](#)

BOB-Campus in Wuppertal
The reuse of existing buildings is a central aim of sustainable construction, since it is the most effective way of conserving resources. It is all t...
[Continue reading](#) [Open document](#)

47 Council Apartments in Barcelona
Back to simple solutions and building physics know-how from centuries ago – this is the approach chosen for the 47 council apartments on the so...
[Continue reading](#) [Open document](#)

DETAIL

2. What kind of information can I find for each project?

Click on the image or on “Continue reading” to access the project preview

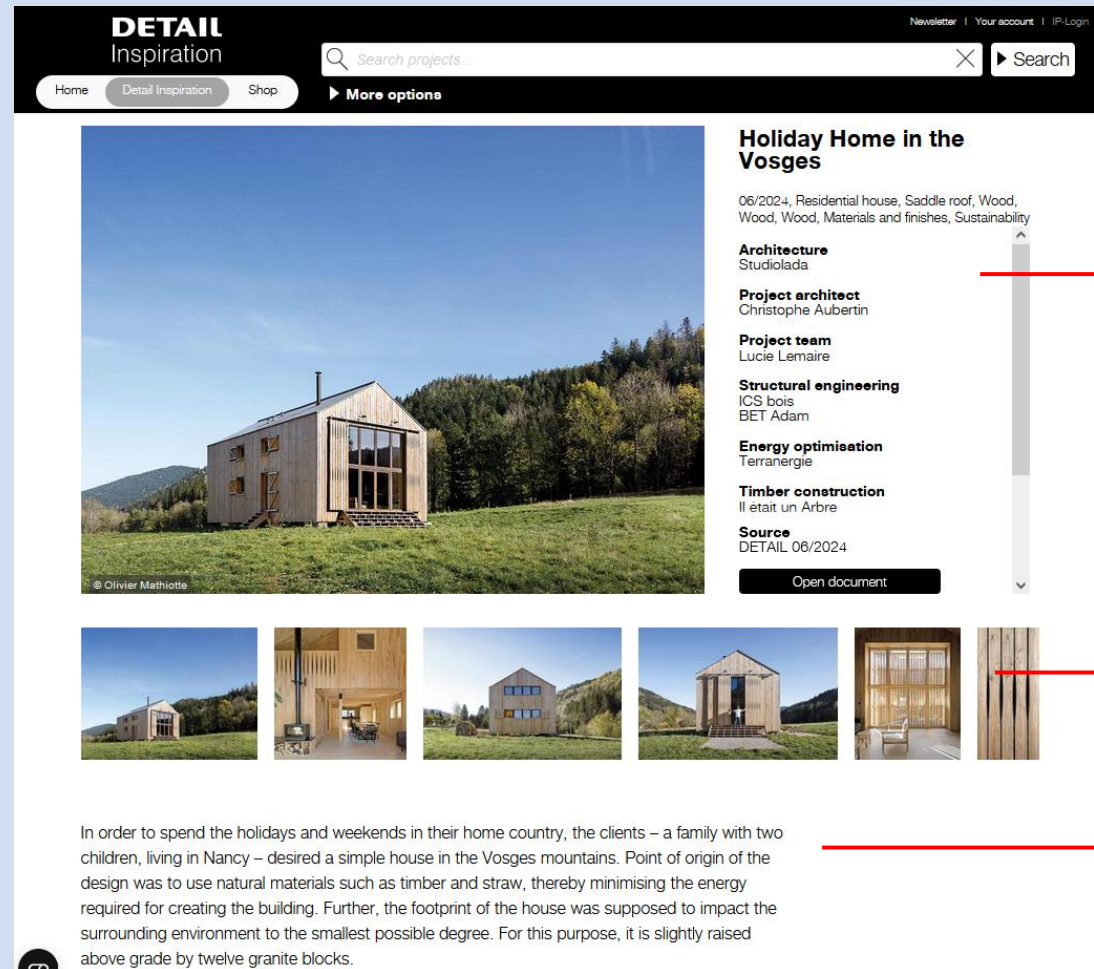
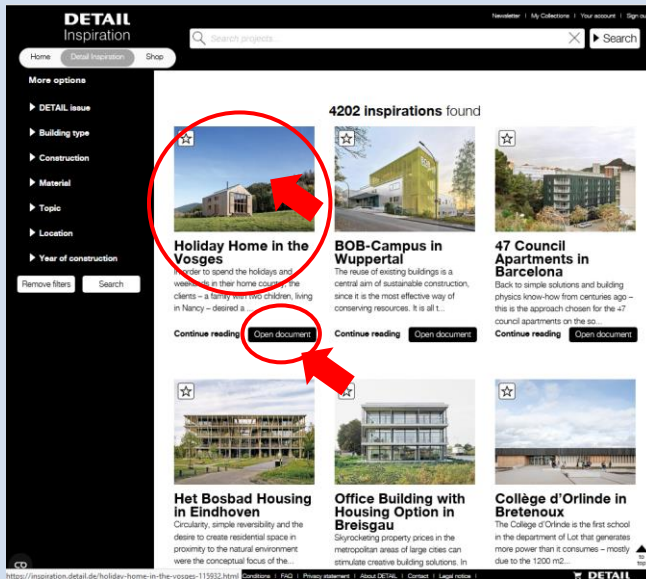

project participants
(scrollable)

picture gallery
(scrollable)

brief project
description

2. What kind of information can I find for each project?

If you click on “Open document”, you will be forward to the entire project documentation.

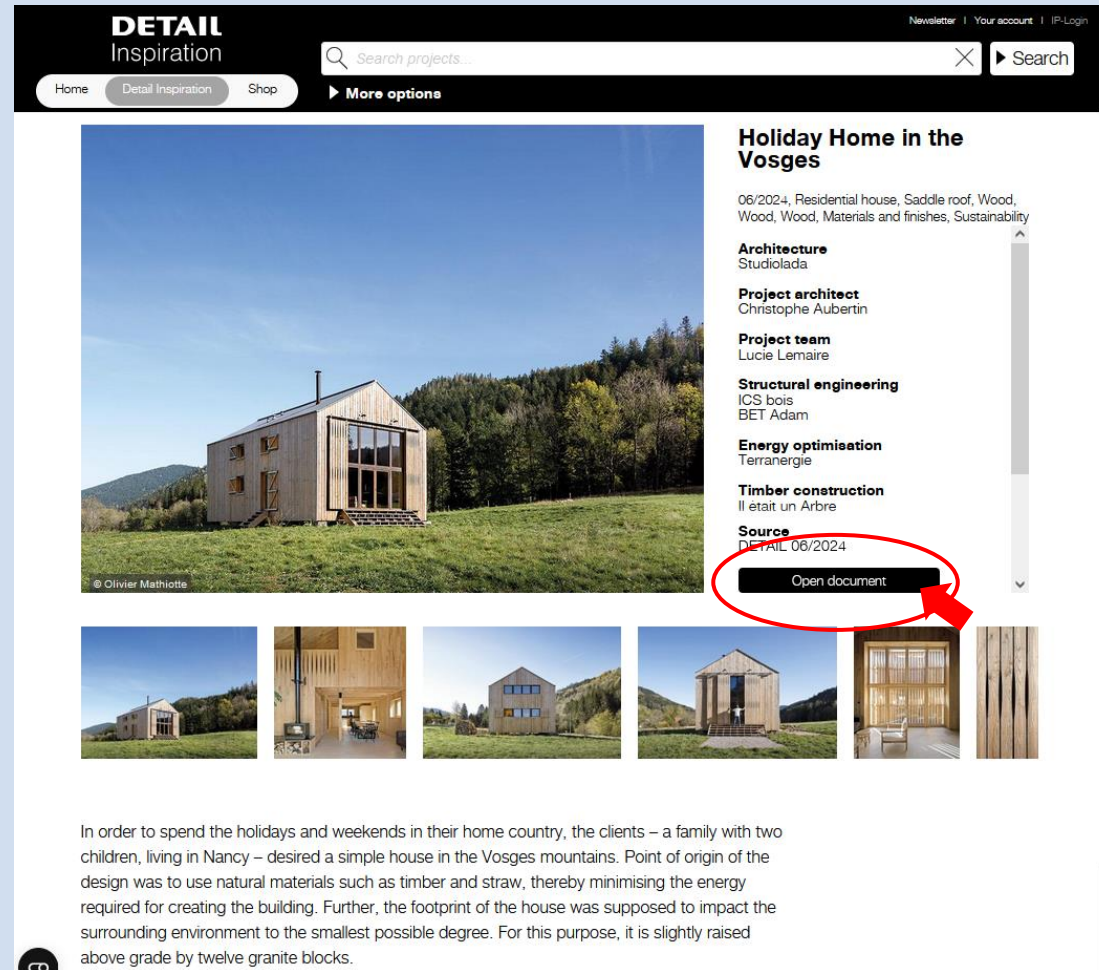
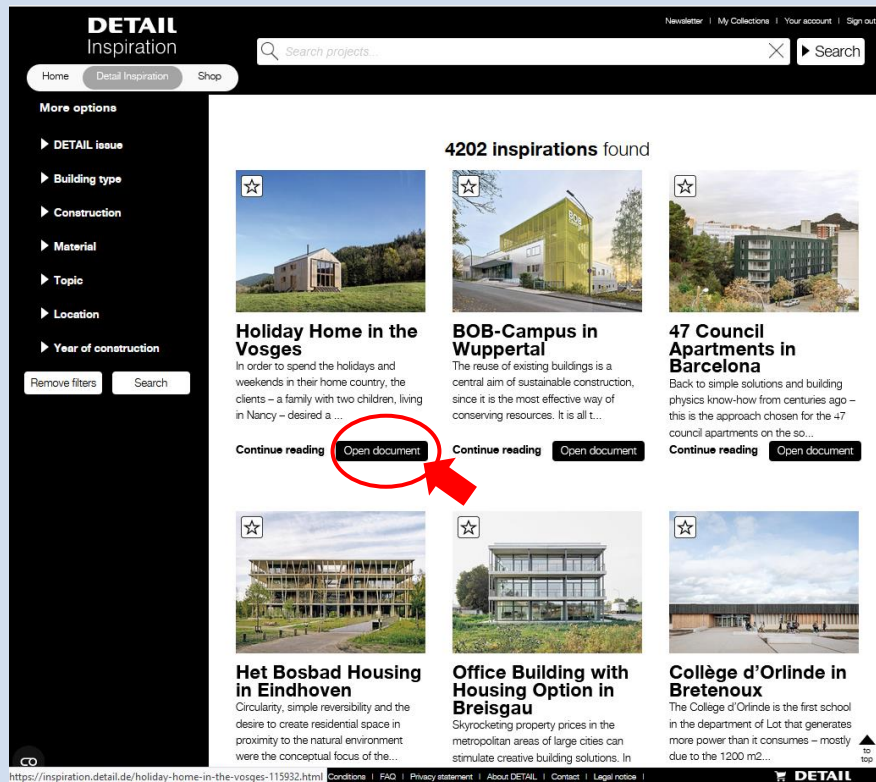

2. What kind of information can I find for each project?

Project documentation: Here you can see the contents that you are familiar with from our print magazine: Photos, maps, layout plans, sections and detailed drawings (in PDF form).

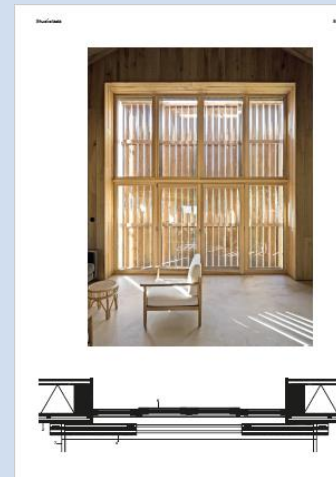
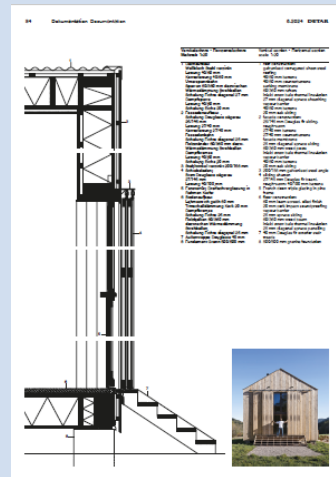
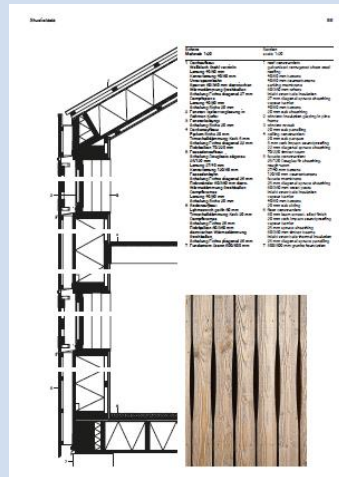
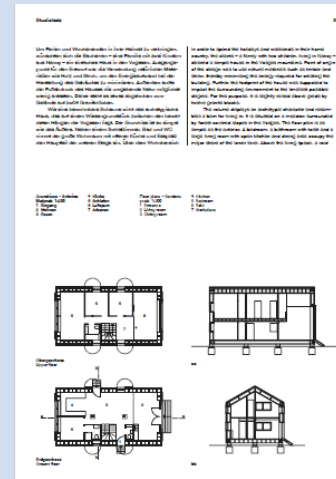
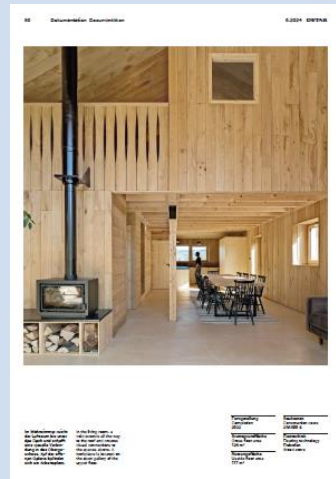

Project documentation can include the following elements:

Editorial text

Photos

Maps

Layout plans

Sections

Detailed drawings 1:20

3. How can I save and download suitable projects?

Directly in your browser you can download the entire project documentation in PDF format to your computer or print it out.

Studiolada

33 (6 von 8)

120 %

Schnitt Maßstab 1:20

Section scale 1:20

1 Dachaufbau: Weilblech Stahl verzinkt Lattung 40/60 mm Konterlattung 40/60 mm Unterspännbahn Sparren 60/360 mm dazwischen Wärmedämmung Strohballen Schalung Fichte diagonal 27 mm Dampfsperre Lattung 40/60 mm Schalung Eiche 20 mm	1 roof construction: galvanised corrugated sheet steel roofing 40/60 mm battens 40/60 mm counterbattens sarking membrane 60/360 mm rafters inlaid straw bale insulation 27 mm diagonal spruce sheathing vapour barrier 40/60 mm battens 20 mm oak sheathing
2 Fenster: Isolierverglasung in Rahmen Kiefer	2 window: insulation glazing in pine frame
3 Fensterlaibung: Schalung Eiche 20 mm	3 window reveal: 20 mm oak panelling
4 Deckenaufbau: Parkett Eiche 20 mm Trittschalldämmung Kork 5 mm Schalung Fichte diagonal 22 mm Holzbalken 70/220 mm	4 ceiling construction: 20 mm oak parquet 5 mm cork impact soundproofing 22 mm diagonal spruce sheathing 70/220 timber beam
5 Fassadenaufbau: Schalung Douglasie sägerau 25/120 mm Lattung 27/40 mm Konterlattung 120/60 mm Fassadenbahn Schalung Fichte diagonal 25 mm Holzständer 60/360 mm dazw. Wärmedämmung Strohballen Dampfbremse Lattung 40/60 mm Schalung Eiche 20 mm	5 facade construction: 25/120 Douglas fir sheathing, rough-sawn 27/40 mm battens 120/60 mm counterbattens facade membrane 25 mm diagonal spruce sheathing 60/360 mm wood posts inlaid straw bale insulation vapour barrier 40/60 mm battens 20 mm oak siding
6 Bodenaufbau: Lehmestrich geölt 60 mm Trittschalldämmung Kork 20 mm Dampfbremse Schalung Fichte 25 mm Holzbalken 60/360 mm dazwischen Wärmedämmung Strohballen Schalung Fichte diagonal 25 mm	6 floor construction: 60 mm loam screed, oiled finish 20 mm cork impact soundproofing vapour barrier 25 mm spruce sheathing 60/360 mm timber beams inlaid straw bale thermal insulation 25 mm diagonal spruce panelling
7 Fundament Granit 500/500 mm	7 500/500 mm granite foundation